

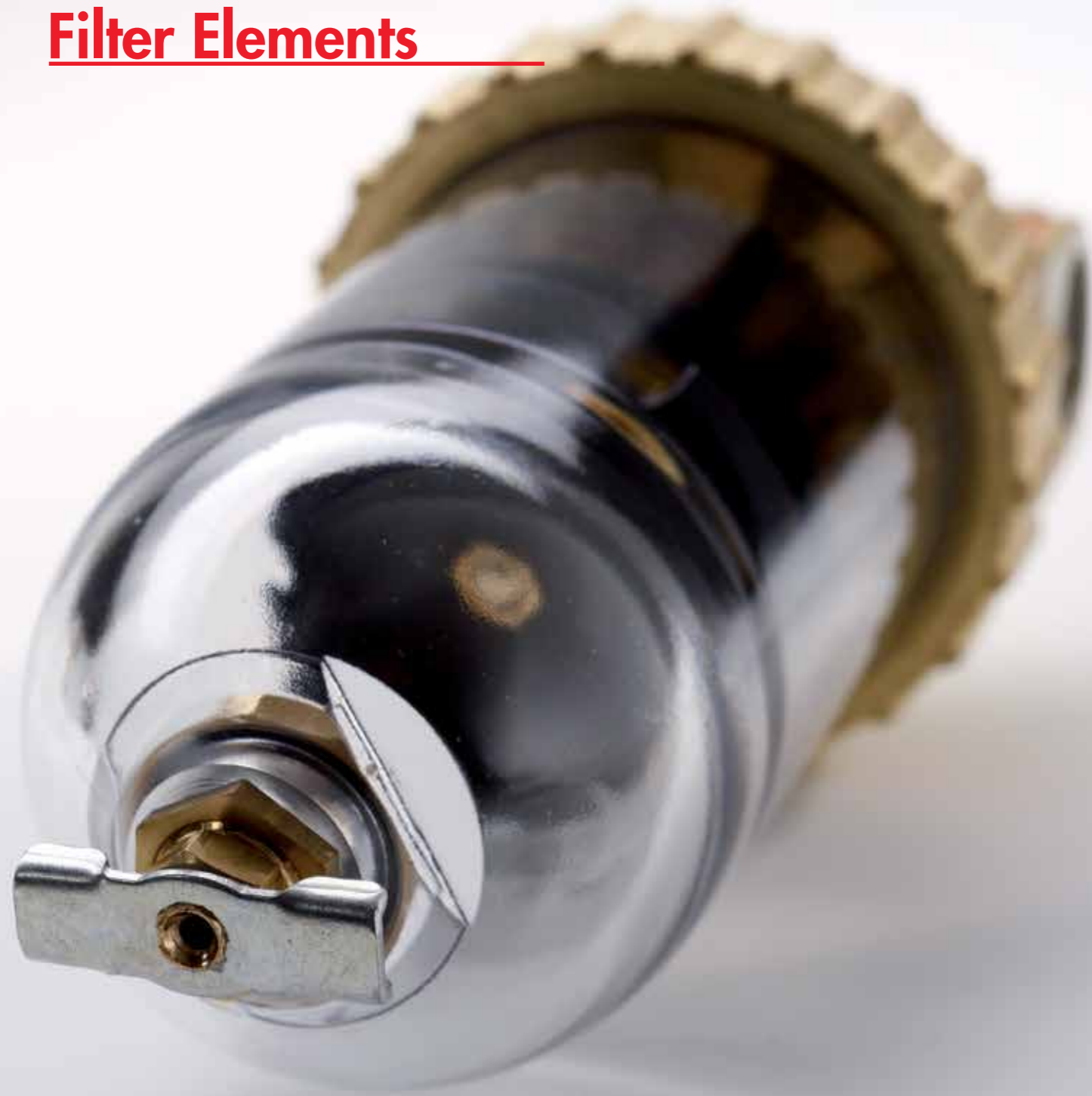







Filter Elements



Filter Elements

Overview

| Filter elements | | Technical details | Description | Page | |
|---|------------------------|-------------------|------------------|--|------|
|  | Vacuum filter VF | Size | G3/8 ... G21/2 | Vacuum filter with metal sheet housing for vacuum pumps and small vacuum blowers | 7.3 |
|  | Vacuum filter SFS | Size | Hose-Ø 50 ... 60 | Vacuum filter with plastic housing for vacuum blowers with high flow rate | 7.5 |
|  | Vacuum filter VFK | Size | G1/8 ... G1/2 | Vacuum filter made of plastic with transparent glass lid for ejectors and small vacuum pumps | 7.7 |
|  | Vacuum filter VFI | Size | Hose-Ø 4 .. 6 | Inline vacuum filter for direct installation in hose lines | 7.9 |
|  | Ventilation filter BFS | Size | G1/8 ... G1 | Ventilation filter for installation on vacuum valves on the ventilation side | 7.11 |
|  | Ventilation filter BF | Size | G1/2 ... G11/2 | Ventilation filter for installation on vacuum valves on the ventilation side | 7.13 |
|  | Water separator WA | Size | G1/2 ... G11/2 | Applications with wet or moist surfaces | 7.15 |

Filter Elements

Vacuum filter VF

Description

Vacuum filter in stable metal sheet housing with exchangeable filter cartridge. The filter cartridge is made of micro fibre which reaches a precipitator efficiency of almost 100%.

Application:

- dirty surfaces and dusty surroundings
- to protect the vacuum generators and valves
- mounting position vertical



VF-3/8 ... VF-21/2

Article number

| Type | | Filter insert |
|----------|-------------|---------------|
| VF-1/2 | 1.53.2.0002 | 2.53.2.0009 |
| VF-3/4 | 1.53.2.0006 | 2.53.2.0014 |
| VF-1 | 1.53.2.0014 | 2.53.2.0005 |
| VF-11/4A | 1.53.2.0003 | 2.53.2.0005 |
| VF-11/4B | 1.53.2.0004 | 2.53.2.0004 |
| VF-21/2 | 1.53.2.0005 | 2.53.2.0006 |

Technical data

| Type | Pressure range (bar) | Flow rate (m ³ /h) | Flow rate (l/s) | Filter grain size (µm) | Temperature (°C) | Weight (kg) |
|----------|----------------------|-------------------------------|-----------------|------------------------|------------------|-------------|
| VF-1/2 | -1 ... 0 | 12 | 3,3 | 5 | -10 ... +60 | 0,12 |
| VF-3/4 | -1 ... 0 | 42 | 11,6 | 5 | -10 ... +60 | 0,60 |
| VF-1 | -1 ... 0 | 85 | 23,6 | 5 | -10 ... +60 | 0,85 |
| VF-11/4A | -1 ... 0 | 96 | 26,6 | 5 | -10 ... +60 | 1,06 |
| VF-11/4B | -1 ... 0 | 108 | 30,0 | 5 | -10 ... +60 | 1,25 |
| VF-21/2 | -1 ... 0 | 360 | 100 | 5 | -10 ... +60 | 1,88 |

FEZER

Simply move more.

Filter Elements

Vacuum filter VF

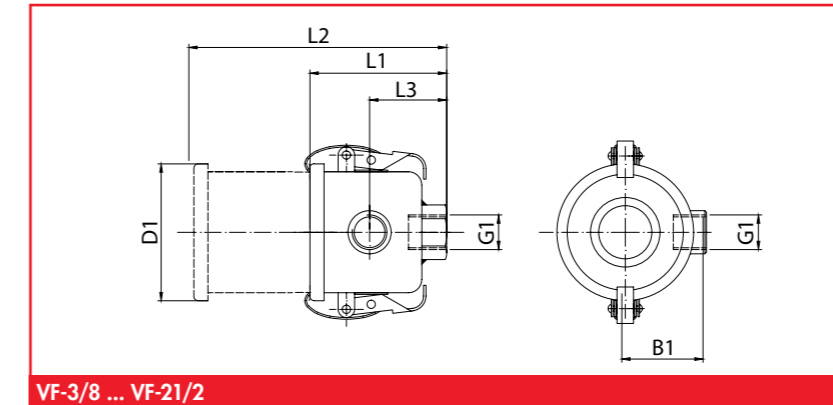

VF-3/8 ... VF-21/2

Dimensions

| Type | D1 | B1 | L1 | L2 | L3 | G1 |
|----------|------|-----|------|-----|------|-------|
| VF-1/2 | 82,5 | 49 | 82,5 | 155 | 46,5 | G 1/2 |
| VF-3/4 | 97 | 59 | 89,5 | 165 | 45 | G3/4 |
| VF-1 | 133 | 76 | 97 | 175 | 51 | G1 |
| VF-11/4A | 136 | 81 | 116 | 195 | 68 | G11/4 |
| VF-11/4B | 172 | 98 | 170 | 310 | 108 | G11/4 |
| VF-21/2 | 194 | 123 | 247 | 470 | 119 | G21/2 |

FEZER

Simply move more.

Filter Elements

Vacuum filter SFS

Description

Very large dust filter consisting of a stable plastic housing and an internal vacuum filter insert. The filter cartridge can be fastened by an appropriate bracket. The filter cartridge can be easily and quickly exchanged or cleaned. The filter is equipped with reductions for hose diameter 50 mm. By removing the reduction the filter can be used for hose diameter 60 mm.

Application:

- for extreme grades of pollution and simultaneously high flow rates (vacuum blowers)
- vertical mounting position



SFS-50

Article number

| Type | | Filter insert | Bracket |
|--------|-------------|---------------|-------------|
| SFS-50 | 4.26.4.0121 | 5.26.4.0007 | 4.26.4.0057 |

Technical data

| Type | Pressure range (bar) | Flow rate (m ³ /h) | Flow rate (l/s) | Filter grain size (µm) | Temperature (°C) | Weight (kg) |
|--------|----------------------|-------------------------------|-----------------|------------------------|------------------|-------------|
| SFS-50 | -1 ... 0 | 260 | 72 | 5 | -5 ... +50 | 2,05 |

FEZER

Simply move more.

Filter Elements

Vacuum filter SFS

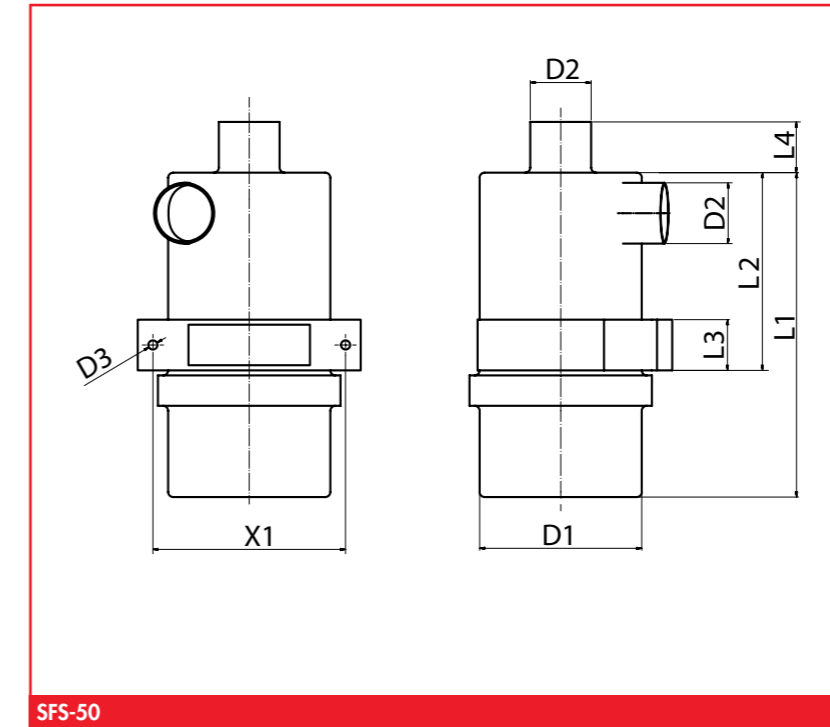

SFS-50

Dimensions

| Type | L1 | L2 | L3 | L4 | D1 | D2 | D3 | X1 |
|--------|-----|-----|----|----|-----|----|----|-----|
| SFS-50 | 320 | 195 | 50 | 60 | 160 | 50 | 9 | 190 |

FEZER

Simply move more.

Filter Elements

Vacuum filter VFT

Description

Vacuum filter with stable and transparent plastic housing. This allows to verify the grade of pollution at any time. The filter cartridge is easily and quickly exchangeable.

Application:

- for medium to high grades of pollution
- to protect vacuum generators and sensitive valves
- horizontal mounting position



VFT-1/8 ... VFT-1/2

Article number

| Type | | Filter insert | Holding plate |
|---------|-------------|---------------|---------------|
| VFT-1/8 | 1.53.2.0020 | 2.53.2.0032 | 2.53.2.0038 |
| VFT-1/4 | 1.53.2.0018 | 2.53.2.0032 | 2.53.2.0038 |
| VFT-3/8 | 1.53.2.0028 | 2.53.2.0032 | 2.53.2.0038 |
| VFT-1/2 | 1.53.2.0021 | 2.53.2.0032 | 2.53.2.0038 |
| VFT-3/4 | 1.53.2.0022 | 2.53.2.0033 | 2.53.2.0039 |

Technical data

| Type | Pressure range (bar) | Flow rate (m ³ /h) | Flow rate (l/s) | Filter grain size (µm) | Temperature (°C) | Weight (kg) |
|---------|----------------------|-------------------------------|-----------------|------------------------|------------------|-------------|
| VFT-1/8 | -1 ... +5 | 30 | 8,3 | 80 | -5 ... +50 | 0,05 |
| VFT-1/4 | -1 ... +5 | 40 | 11,1 | 80 | -5 ... +50 | 0,05 |
| VFT-3/8 | -1 ... +5 | 45 | 12,5 | 80 | -5 ... +50 | 0,08 |
| VFT-1/2 | -1 ... +5 | 80 | 22,2 | 80 | -5 ... +50 | 0,08 |
| VFT-3/4 | -1 ... +5 | 108 | 30,0 | 80 | -5 ... +50 | 0,15 |

FEZER

Simply move more.

Filter Elements

Vacuum filter VFT

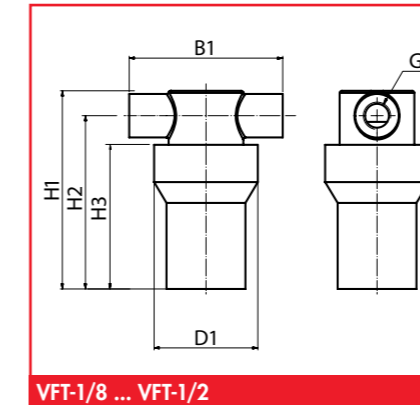

VFT-1/8 ... VFT-1/2

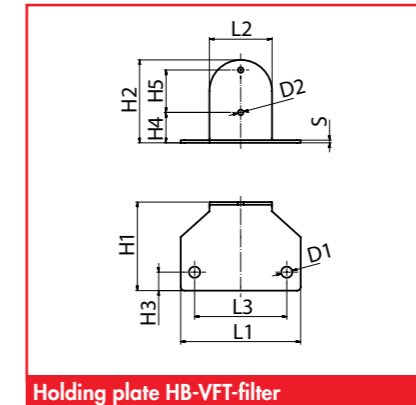

Holding plate HB-VFT-filter

Dimensions filter

| Type | H1 | H2 | H3 | B1 | B2 | D1 | G1 |
|---------|-------|-----|------|----|----|----|------|
| VFT-1/8 | 92,5 | 83 | 69,5 | 58 | 29 | 50 | G1/8 |
| VFT-1/4 | 95,5 | 85 | 69,5 | 74 | 37 | 50 | G1/4 |
| VFT-3/8 | 98,5 | 86 | 69,5 | 74 | 37 | 50 | G3/8 |
| VFT-1/2 | 102,5 | 88 | 69,5 | 74 | 37 | 50 | G1/2 |
| VFT-3/4 | 134 | 117 | 92 | 90 | 48 | 76 | G3/4 |

Dimensions holding plate

| Type | L1 | L2 | L3 | H1 | H2 | H3 | H4 | H5 | D1 | D2 | S |
|------------|----|----|----|----|----|----|------|----|----|----|-----|
| HB-VFT-1/8 | 65 | 34 | 50 | 48 | 45 | 10 | 16,5 | 23 | 6 | 3 | 1,5 |
| HB-VFT-1/4 | 65 | 34 | 50 | 48 | 45 | 10 | 16,5 | 23 | 6 | 3 | 1,5 |
| HB-VFT-3/8 | 65 | 34 | 50 | 48 | 45 | 10 | 16,5 | 23 | 6 | 3 | 1,5 |
| HB-VFT-1/2 | 65 | 34 | 50 | 48 | 45 | 10 | 16,5 | 23 | 6 | 3 | 1,5 |
| HBVFT-3/4 | 85 | 51 | 70 | 52 | 70 | 10 | 26,5 | 33 | 6 | 3 | 1,5 |

FEZER

Simply move more.

Filter Elements

Vacuum filter inline VFI

Description

Compact vacuum filter for in-line-installation, straight into the hose lines. The transparent housing shows the grade of pollution at all times. The filter inserts can be exchanged easily and quickly.

Application:

- on applications with slight to medium grade of pollution
- straight installation into the hose lines
- any mounting position



VFI-4 ... VFI 8

Article number

| Type | Article number |
|-------|----------------|
| VFI-4 | 1.53.2.0029 |
| VFI-6 | 1.53.2.0013 |
| VFI-8 | 1.53.2.0015 |

Technical data

| Type | Pressure range (bar) | Flow rate (m³/h) | Flow rate (l/s) | Filter grain size (µm) | Temperature (°C) | Weight (kg) |
|-------|----------------------|------------------|-----------------|------------------------|------------------|-------------|
| VFI-4 | -1 ... +7 | 1,6 | 0,45 | 50 | -5 ... +50 | 0,004 |
| VFI-6 | -1 ... +7 | 4,2 | 1,2 | 50 | -5 ... +50 | 0,006 |
| VFI-8 | -1 ... +7 | 7,5 | 2,1 | 50 | -5 ... +50 | 0,010 |

FEZER

Simply move more.

Filter Elements

Vacuum filter inline VFI

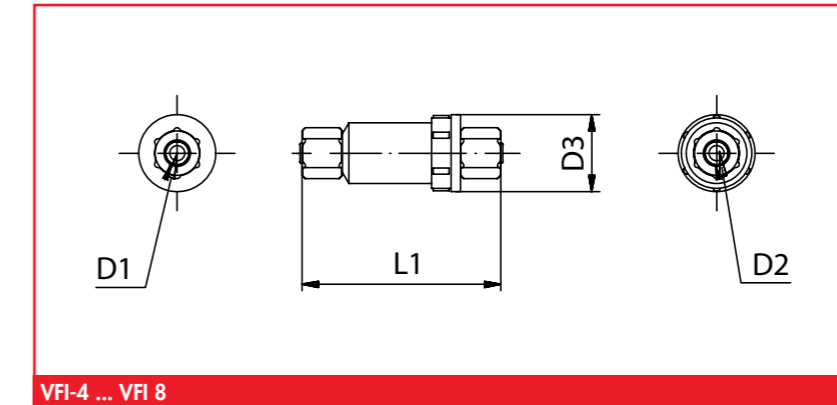

VFI-4 ... VFI 8

Dimensions

| Type | L1 | D1 | D2 | D3 |
|-------|----|----|----|----|
| VFI-4 | 50 | 4 | 4 | 16 |
| VFI-6 | 56 | 6 | 6 | 16 |
| VFI-8 | 62 | 8 | 8 | 24 |

FEZER

Simply move more.

Filter Elements

Ventilation filter BFS

Description

Robust ventilation filter in sintered metal design. Its small size allows to use the filter in cramped spaces. To clean them the ventilation filters can be blown out with compressed air contrary to the suction direction.

Application:

- to protect vacuum valves on the ventilation side
- any mounting position



BFS-1/4 ... BFS-3/4

Article number

| Type | Article number |
|---------|----------------|
| BFS-1/8 | 1.53.1.0012 |
| BFS-1/4 | 1.53.1.0013 |
| BFS-1/2 | 1.53.1.0014 |
| BFS-3/4 | 1.53.1.0015 |
| BFS-1 | 1.53.1.0016 |

Technical data

| Type | Pressure range (bar) | Flow rate (m³/h) | Flow rate (l/s) | Filter grain size (µm) | Temperature (°C) | Weight (kg) |
|---------|----------------------|------------------|-----------------|------------------------|------------------|-------------|
| BFS-1/8 | -1 ... +10 | 10 | 2,8 | 93 | -10 ... +60 | 0,006 |
| BFS-1/4 | -1 ... +10 | 16,5 | 4,5 | 145 | -10 ... +60 | 0,012 |
| BFS-1/2 | -1 ... +10 | 30 | 8,3 | 407 | -10 ... +60 | 0,041 |
| BFS-3/4 | -1 ... +10 | 60 | 16,6 | 762 | -10 ... +60 | 0,083 |
| BFS-1 | -1 ... +10 | 90 | 25 | 900 | -10 ... +60 | 0,144 |

FEZER

Simply move more.

Filter Elements

Ventilation filter BFS

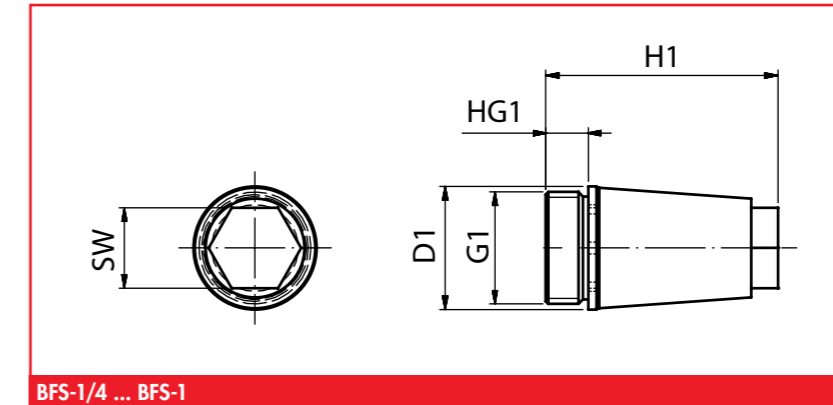

BFS-1/4 ... BFS-1

Dimensions

| Type | D1 | H1 | G1 | HG1 | SW |
|---------|------|------|------|-----|----|
| BFS-1/8 | 11,5 | 21,5 | G1/8 | 4,5 | 8 |
| BFS-1/4 | 15 | 28 | G1/4 | 6 | 10 |
| BFS-1/2 | 23 | 43,5 | G1/2 | 8 | 15 |
| BFS-3/4 | 30 | 56 | G3/4 | 9 | 19 |
| BFS-1 | 37 | 68,5 | G1 | 11 | 24 |

FEZER

Simply move more.

Filter Elements

Ventilation filter BF

Description

Robust ventilation filter in stable sheet metal housing. The large surface provides a high grade of separation of dirt particles. To clean them the ventilation filters can be blown out with compressed air contrary to the suction direction.

Application:

- to protect vacuum valves on the ventilation side
- any mounting position



BF-1/2 ... BF 11/2

Article number

| Type | |
|---------|-------------|
| BF-1/2 | 1.53.1.0003 |
| BF-3/4 | 1.53.1.0008 |
| BF-1 | 1.53.1.0009 |
| BF-11/2 | 1.53.1.0010 |

Technical data

| Type | Pressure range (bar) | Flow rate (m³/h) | Flow rate (l/s) | Filter grain size (µm) | Temperature (°C) | Weight (kg) |
|---------|----------------------|------------------|-----------------|------------------------|------------------|-------------|
| BF-1/2 | -1 ... +8 | 90 | 25 | 60 | -10 ... +60 | 0,10 |
| BF-3/4 | -1 ... +8 | 110 | 30,7 | 60 | -10 ... +60 | 0,12 |
| BF-1 | -1 ... +8 | 160 | 44,4 | 60 | -10 ... +60 | 0,16 |
| BF-11/2 | -1 ... +8 | 240 | 66,6 | 60 | -10 ... +60 | 0,33 |

FEZER

Simply move more.

Filter Elements

Ventilation filter BF

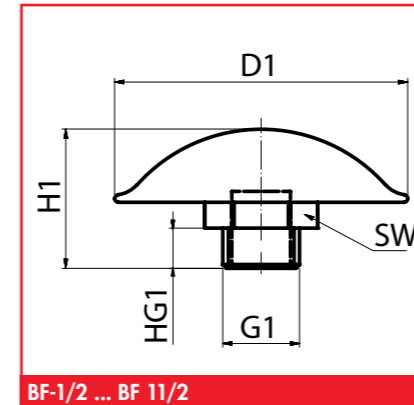

BF-1/2 ... BF 11/2

Dimensions

| Type | D1 | H1 | G1 | HG1 | SW |
|---------|----|----|-------|-----|----|
| BF-1/2 | 80 | 27 | G1/2 | 11 | 27 |
| BF-3/4 | 80 | 45 | G3/4 | 20 | 36 |
| BF-1 | 80 | 47 | G1 | 20 | 46 |
| BF-11/2 | 80 | 58 | G11/2 | 22 | 46 |

FEZER

Simply move more.

Filter Elements

Water separator WAS

Description

Water separator with manual drainage screw and inspection window for visual control. Holding fixture made of stable brass die-cast. The water separator is used to protect valves and pumps from moisture. The drainage screw allows to drain the condensate manually.

Application:

- handling of moist to wet workpieces
- on water spray machines and out-door applications
- mounting position horizontal



WAS-1/2 ... WAS-1

Article number

| Type | | Spare glass | Drainage screw |
|----------|-------------|-------------|----------------|
| WAS-1/2 | 1.53.4.0001 | 2.53.4.0003 | 2.53.4.0005 |
| WAS-3/4 | 1.53.4.0002 | 2.53.4.0001 | 2.53.4.0005 |
| WAS-1 | 1.53.4.0006 | 2.53.4.0001 | 2.53.4.0005 |
| WAS-11/4 | 1.53.4.0004 | 2.53.4.0001 | 2.53.4.0005 |
| WAS-11/2 | 1.53.4.0005 | 2.53.4.0001 | 2.53.4.0005 |

Technical data

| Type | Pressure range (bar) | Flow rate (m ³ /h) | Flow rate (l/s) | Filter grain size (µm) | Volume (l) | Temperature (°C) | Weight (kg) |
|----------|----------------------|-------------------------------|-----------------|------------------------|------------|------------------|-------------|
| WAS-1/2 | -1 ... +8 | 60 | 16,6 | 40 | 0,080 | +10 ... +50 | 1,2 |
| WAS-3/4 | -1 ... +8 | 288 | 80 | 40 | 0,260 | +10 ... +50 | 1,9 |
| WAS-1 | -1 ... +8 | 306 | 85 | 40 | 0,260 | +10 ... +50 | 1,9 |
| WAS-11/4 | -1 ... +8 | 378 | 105 | 40 | 0,260 | +10 ... +50 | 1,9 |
| WAS-11/2 | -1 ... +8 | 396 | 110 | 40 | 0,260 | +10 ... +50 | 1,9 |

FEZER

Simply move more.

Filter Elements

Water separator WAS

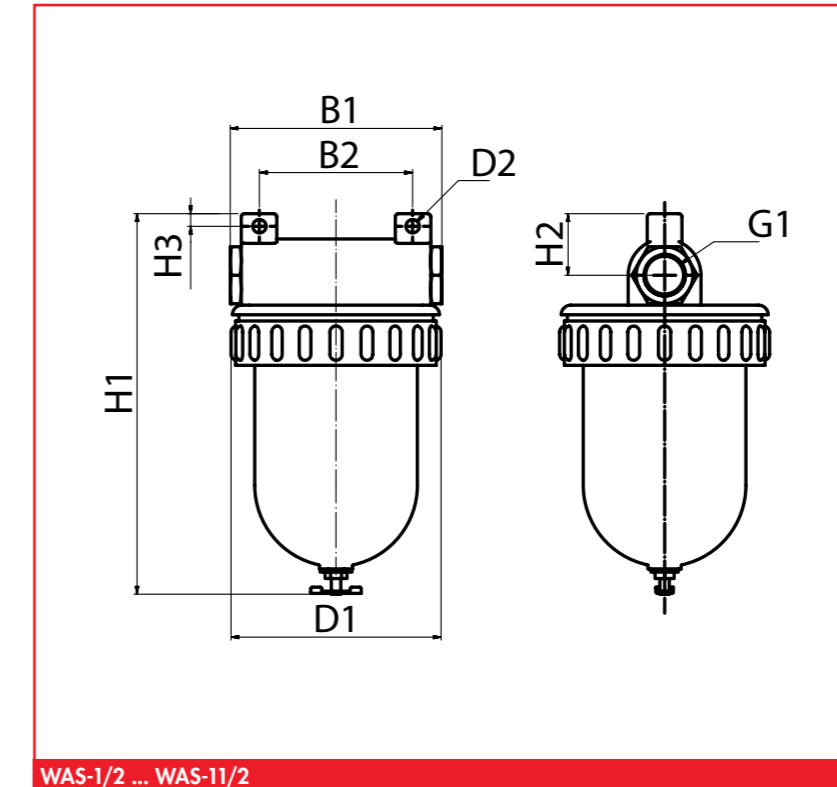

WAS-1/2 ... WAS-11/2

Dimensions

| Type | D1 | D2 | B1 | B2 | H1 | H2 | H3 | G1 |
|----------|-----|-----|-----|----|-----|----|----|-------|
| WAS-1/2 | 87 | 6 | 80 | 50 | 196 | 24 | 6 | G1/2 |
| WAS-3/4 | 133 | 8,4 | 120 | 97 | 241 | 36 | 8 | G3/4 |
| WAS-1 | 133 | 8,4 | 134 | 97 | 241 | 36 | 8 | G1 |
| WAS-11/4 | 133 | 8,4 | 134 | 97 | 241 | 45 | 8 | G11/4 |
| WAS-11/2 | 133 | 8,4 | 134 | 97 | 241 | 45 | 8 | G11/2 |

FEZER

Simply move more.